

Conquer fuse clips are professional designed for varies of circuits and fusing applications. These clips are available in several finishing's and base materials which meet specific current, strength, and conductivity requirements.

### CQ-301B

For 3.6mm Dia. Fuses

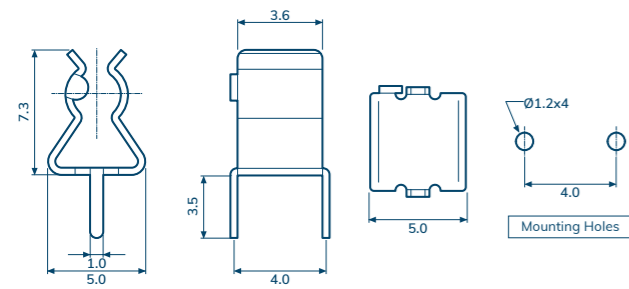

### CQ-203B

For 5mm Dia. Fuses

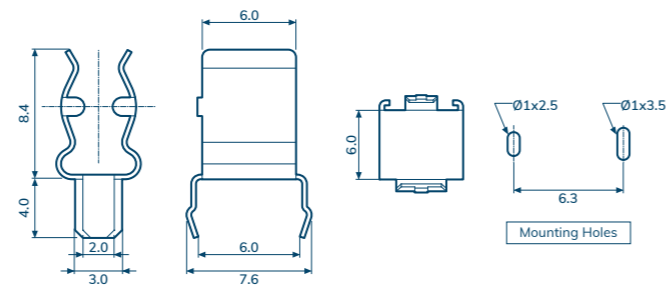

### CQ-203K

For 5mm Dia. Fuses

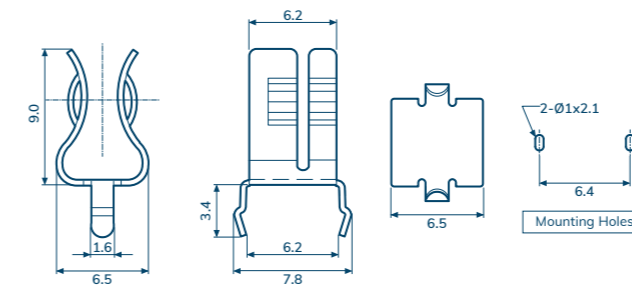

### CQ-203LR

For 5mm Dia. Fuses

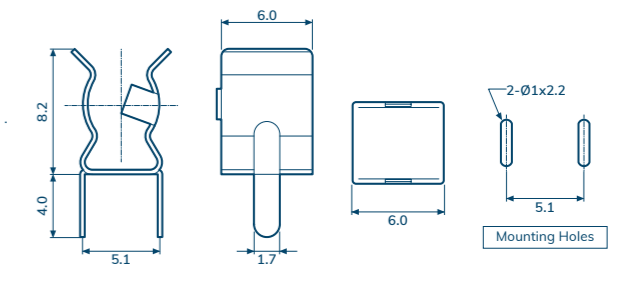

### CQ-203E

For 5mm Dia. Fuses

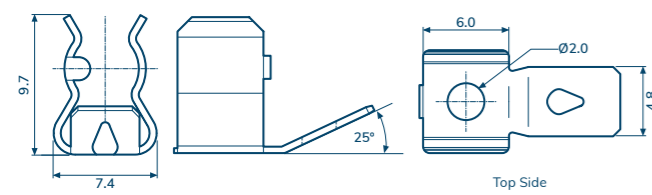

### CQ-203H

For 5mm Dia. Fuses

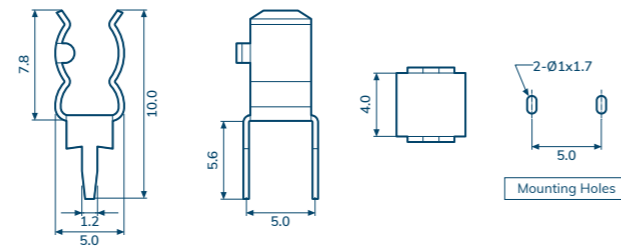

### CQ-203P

For 5mm Dia. Fuses

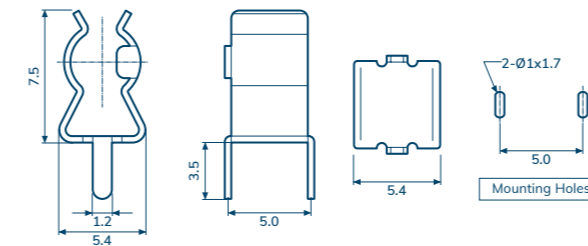

### CQ-203S

For 5mm Dia. Fuses

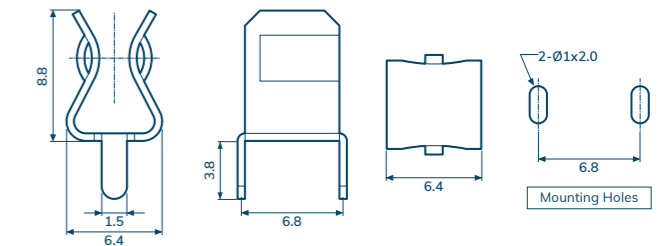

Item Number	CQ-301B	CQ-203B	CQ-203E	CQ-203H
Metal Material	Brass	Phosphor Bronze	Phosphor Bronze	Brass
Material Thickness	0.4 mm	0.3 mm	0.5 mm	0.4 mm
Suitable Rated Current	10 A	10 A	15 A	10 A
Fuse Type	Ear Type	Ear Type	Ear Type	Ear Type
Plating Type	Bright Tin Plated	Bright Tin Plated	Bright Tin Plated	Bright Tin Plated

Item Number	CQ-203K	CQ-203LR	CQ-203P	CQ-203S
Metal Material	Phosphor Bronze	Phosphor Bronze	Brass	Brass
Material Thickness	0.4 mm	0.3 mm	0.4 mm	0.5 mm
Suitable Rated Current	10 A	10 A	10 A	15 A
Fuse Type	Ear Type	Ear Type	Ear Type	Ear Type
Plating Type	Bright Tin Plated	Bright Tin Plated	Bright Tin Plated	Bright Tin Plated

Conquer fuse clips are professional designed for varies of circuits and fusing applications. These clips are available in several finishing's and base materials which meet specific current, strength, and conductivity requirements.

### CQ-203SF(C)

For 5mm Dia. Fuses

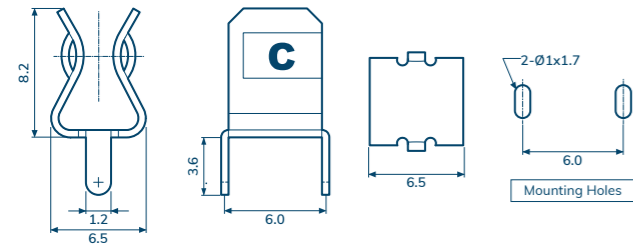

### CQ-203SP

For 5mm Dia. Fuses

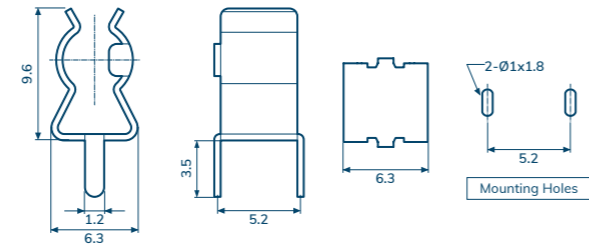

### CQ-203T

For 5mm Dia. Fuses

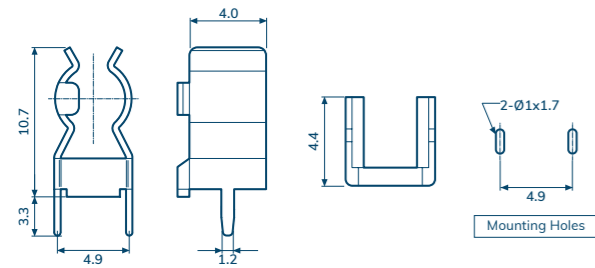

### CQ-205B

For 6.3mm Dia. Fuses

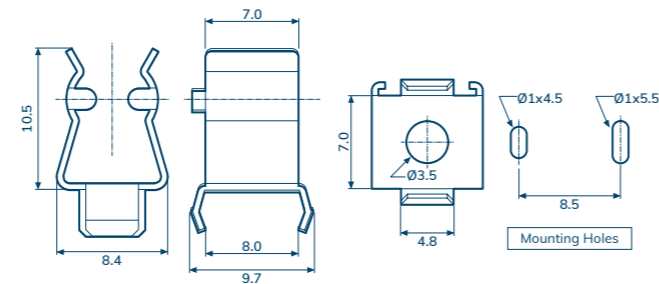

### CQ-205D

For 6.3mm Dia. Fuses

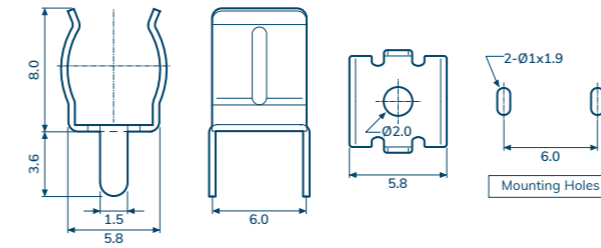

### CQ-205E

For 6.3mm Dia. Fuses

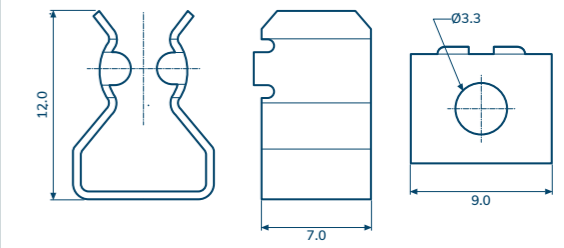

### CQ-205DH

For 6.3mm Dia. Fuses

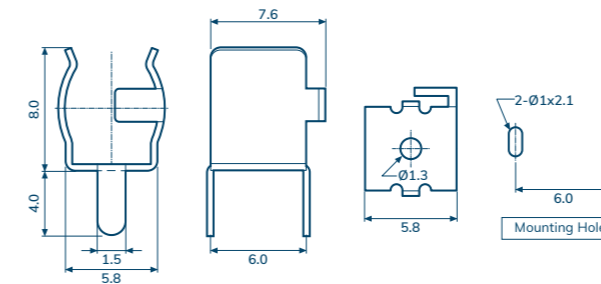

### CQ-205S

For 6.3mm Dia. Fuses

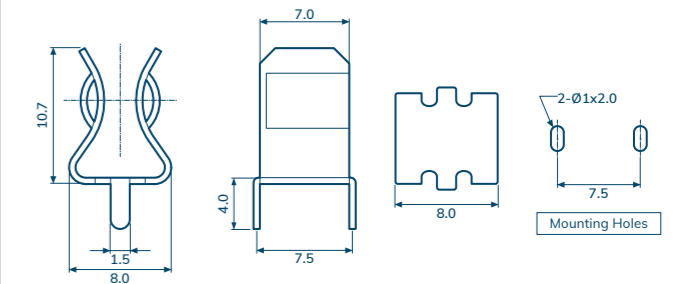

Item Number	CQ-203SF(C)	CQ-203SP	CQ-203T	CQ-205B
Metal Material	Brass	Brass	Brass	Brass
Material Thickness	0.4 mm	0.4 mm	0.4 mm	0.5 mm
Suitable Rated Current	10 A	10 A	10 A	15 A
Fuse Type	Ear Type	Ear Type	Ear Type	Ear Type
Plating Type	Bright Tin Plated	Bright Tin Plated	Bright Tin Plated	Bright Tin Plated

Item Number	CQ-205D	CQ-205E	CQ-205DH	CQ-205S
Metal Material	Brass	Phosphor Bronze	Phosphor Bronze	Brass
Material Thickness	0.4 mm	0.5 mm	0.4 mm	0.5 mm
Suitable Rated Current	15 A	15 A	15 A	25 A
Fuse Type	Ear Type	Ear Type	Ear Type	Ear Type
Plating Type	Bright Tin Plated	Bright Tin Plated	Bright Tin Plated	Bright Tin Plated

Conquer fuse clips are professional designed for varies of circuits and fusing applications. These clips are available in several finishing's and base materials which meet specific current, strength, and conductivity requirements.

### CQ-205SPP

For 6.3mm Dia. Fuses

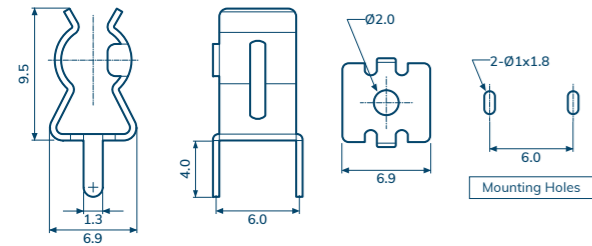

### CQ-111

For Blade Auto Fuse ATQ Type

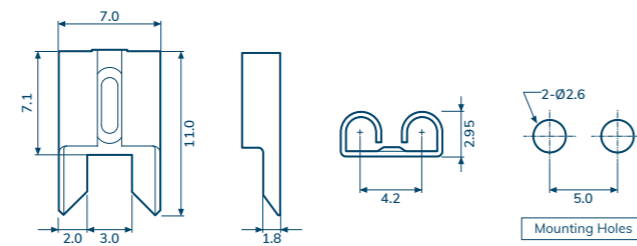

### CQ-112

For AST Mini Blade Type Fuse

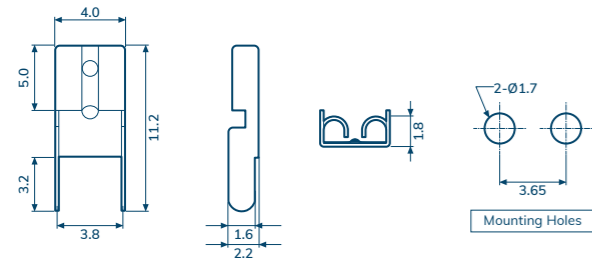

### CQ-114

For ATQ Blade Horizontal Clip

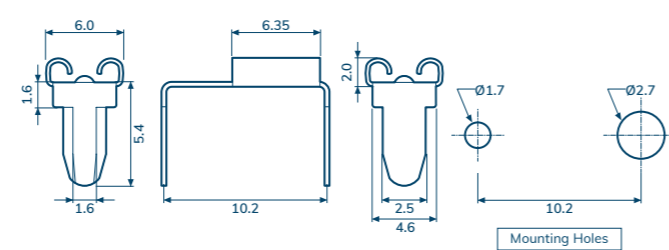

### CQ-115

For AST Mini BladeType Fuse

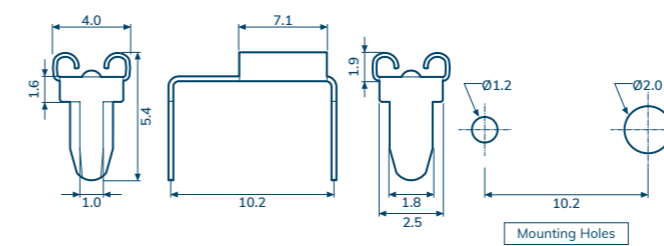

### CQ-216(G)

For 10.3mm Dia. Fuses

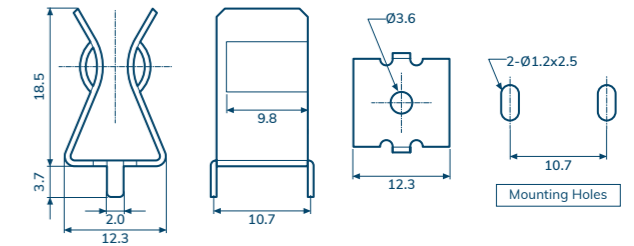

### CQ-05CT

Tape / Reel For 5mm Dia. Fuse

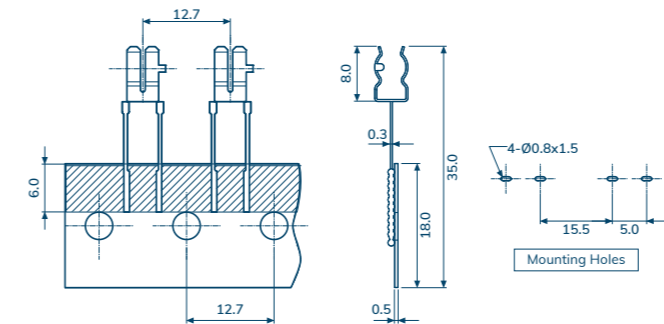

### CQ-216

For 10.3mm Dia. Fuses

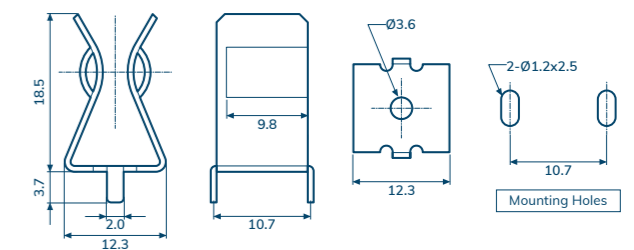

Item Number	CQ-205SPP	CQ-111	CQ-112	CQ-114
Metal Material	Phosphor Bronze	Brass	Brass	Brass
Material Thickness	0.5 mm	0.35 mm	0.3 mm	0.3 mm
Suitable Rated Current	15 A	15 A	20 A	15 A
Fuse Type	Ear Type	ATQ Type	AST Type	ATQ Type
Plating Type	Bright Tin Plated	Bright Tin Plated	Bright Tin Plated	Bright Tin Plated

Item Number	CQ-115	CQ-216(G)	CQ-05CT	CQ-216
Metal Material	Brass	Brass	Phosphor Bronze	Brass
Material Thickness	0.3 mm	0.7 mm	0.3 mm	0.7 mm
Suitable Rated Current	15 A	30 A	10 A	30 A
Fuse Type	AST Type	Ear Type	Ear Type	Ear Type
Plating Type	Bright Tin Plated	24Kt. Gold Plated	Bright Tin Plated	Bright Tin Plated